

# JOINT PUBLIC NOTICE

January 11, 2016

United States Army  
Corps of Engineers  
New Orleans District  
Regulatory Branch  
Post Office Box 60267  
New Orleans, Louisiana 70160-0267

State of Louisiana  
Department of Environmental Quality  
Water Quality Certifications Section  
Post Office Box 4313  
Baton Rouge, Louisiana 70821-4313

(504) 862-2272  
Project Manager  
Amy Oestringer  
[Amy.L.Oestringer@usace.army.mil](mailto:Amy.L.Oestringer@usace.army.mil)  
MVN 2015-02096-WQQ

(225) 219-3225  
Project Manager  
Ms. Elizabeth Hill  
WQC Application Number  
WQC 160107-02

Interested parties are hereby notified that a permit application has been received by the New Orleans District of the U.S. Army Corps of Engineers pursuant to: [X] Section 10 of the Rivers and Harbors Act of March 3, 1899 (30 Stat. 1151; 33 USC 403); and/or [X] Section 404 of the Clean Water Act (86 Stat. 816; 33 USC 1344).

Application has also been made to the Louisiana Department of Environmental Quality, Office of Environmental Services, for a Water Quality Certification (WQC) in accordance with statutory authority contained in LRS30:2074 A(3), and provisions of Section 401 of the Clean Water Act (P.L.95-17).

## **EROSION CONTROL MEASURES AND BRIDGE REPLACEMENTS IN CONTRABAND BAYOU IN LAKE CHARLES, LOUISIANA IN CALCASIEU PARISH**

**NAME OF APPLICANT:** McNeese State University, c/o Arabie Environmental Solutions, Attn: Cleveland Hoffpauir, 510 Clarence Street, Lake Charles, Louisiana 70601.

**LOCATION OF WORK:** Located within Contraband Bayou, in Section 19, Township 10 South, Range 8 West, in Lake Charles, Louisiana, in Calcasieu Parish, as shown on the enclosed drawings (Latitude 30.176989 N Longitude -93.215819 W). This project is located in USGS Hydrologic Unit Code (HUC) 08080206-Lower Mississippi Region.

**CHARACTER OF WORK:** The applicant is proposing the installation and maintenance of erosion control improvements along the north and south banks of Contraband Bayou in an area between Ryan Street and Common Street. A steel sheet pile retaining wall, concrete cap, intermittent paved concrete slope revetment, turf reinforcement mat and concrete block gravity retaining wall will be installed. Two pedestrian bridges and a utility bridge will be reconstructed to provide access to the university from adjacent buildings and parking areas. These current bridges are in poor structural condition and require replacement. Approximately 10,000 cubic yards of existing concrete rip/rap debris will be removed and approximately 5,000 cubic yards of graded and/or hauled in earthen materials will be placed for slope improvements along the bayou banks. In addition, 2,500 linear feet of sheet pile retaining wall with a concrete cap and 6,000 cubic yards of hauled in earthen material will be placed for erosion control measures, as shown on the attached permit drawings. No wetland impacts are proposed and therefore no compensatory mitigation will be required.

The comment period for the Department of the Army Permit and the Louisiana Department of Environmental Quality WQC will close **20 days** from the date of this joint public notice. Written comments, including suggestions for modifications or objections to the proposed work, stating reasons thereof, are being solicited from anyone having interest in this

permit and/or this WQC request and must be mailed so as to be received before or by the last day of the comment period. Letters concerning the Corps of Engineers permit application must reference the applicant's name and the Permit Application Number, and be mailed to the Corps of Engineers at the address above, **ATTENTION: REGULATORY BRANCH**. Individuals or parties may request an extension of time in which to comment on the proposed work by writing to the project manager or clicking on the project manager's name on the public notice grid on the web page. Any request must be specific and substantively supportive of the requested extension, and received by this office prior to the end of the initial comment period. The Section Chief will review the request and the requestor will be promptly notified of the decision to grant or deny the request. If granted, the time extension will be continuous to the initial comment period and, inclusive of the initial comment period, will not exceed a total of 30 calendar days. Letters concerning the Water Quality Certification must reference the applicant's name and the WQC Application number and be mailed to the Louisiana Department of Environmental Quality at the address above.

The application for this proposed project is on file with the Louisiana Department of Environmental Quality and may be examined during weekdays between 8:00 a.m. and 4:30 p.m. Copies may be obtained upon payment of costs of reproduction.

### **Corps of Engineers Permit Criteria**

The decision whether to issue a permit will be based on an evaluation of the probable impacts, including cumulative impacts of the proposed activity on the public interest. That decision will reflect the national concern for both protection and utilization of important resources. The benefit which reasonably may be expected to accrue from the proposal must be balanced against its reasonably foreseeable detriments. All factors which may be relevant to the proposal will be considered including the cumulative effects thereof; among those are conservation, economics, aesthetics, general environmental concerns, wetlands, historic properties, fish and wildlife values, flood hazards, floodplain values, land use, navigation, shoreline erosion and accretion, recreation, water supply and conservation, water quality, energy needs, safety, food and fiber production, mineral needs, considerations of property ownership and, in general, the needs and welfare of the people.

The U.S. Army Corps of Engineers is soliciting comments from the public, federal, state, and local agencies and officials, Indian Tribes, and other interested parties in order to consider and evaluate the impacts of this proposed activity. Any comments received will be considered by the U.S. Army Corps of Engineers to determine whether to make, modify, condition, or deny a permit for this proposal. To make this decision, comments are used to assess impacts on endangered species, historic properties, water quality, general environmental effects, and other public interest factors listed above. Comments are used in the preparation of an Environmental Assessment and/or an Environmental Impact Statement pursuant to the National Environmental Policy Act. Comments are also used to determine the need for a public hearing and to determine the overall public interest of the proposed activity.

The New Orleans District is unaware of properties listed on the National Register of Historic Places near the proposed work. The possibility exists that the proposed work may damage or destroy presently unknown archeological, scientific, prehistorical, historical sites, or data. Issuance of this public notice solicits input from the State Archeologist and State Historic Preservation Officer regarding potential impacts to cultural resources.

Our initial finding is that the proposed work would neither affect any species listed as endangered by the U.S. Departments of Interior or Commerce, nor affect any habitat designated as critical to the survival and recovery of any endangered species. Utilizing Standard Local Operating Procedure for Endangered Species in Louisiana (SLOPES), dated October 22, 2014, between the U.S. Army Corps of Engineers, New Orleans and U.S. Fish and Wildlife Service, Ecological Services Office, the Corps has determined that the proposed activity would have no effect on any listed species.

This notice initiates the Essential Fish Habitat (EFH) consultation requirements of the Magnuson-Stevens Fishery Conservation and Management Act. The applicant's proposal would result in the destruction or alteration of NA acres of EFH utilized by various life stages of red drum and penaeid shrimp. Our initial determination is that the proposed action would not have a substantial adverse impact on EFH or federally managed fisheries in the Gulf of Mexico. Our final determination relative to project impacts and the need for mitigation measures is subject to review by and coordination with the National Marine Fisheries Service.

If the proposed work involves deposits of dredged or fill material into navigable waters, the evaluation of the probable impacts will include the application of guidelines established by the Administrator of the Environmental Protection Agency. Also, a certification that the proposed activity will not violate applicable water quality standards will be required from the Department of Environmental Quality, Office of Environmental Services, before a permit is issued.

Any person may request, in writing, within the comment period specified in this notice, that a public hearing be held to consider this application. Requests for public hearings shall state, with particularity, the reasons for holding a public hearing.

You are requested to communicate the information contained in this notice to any other parties whom you deem likely to have interest in the matter.

Darrell S. Barbara  
Chief, Western Evaluation Section  
Regulatory Branch

Enclosure



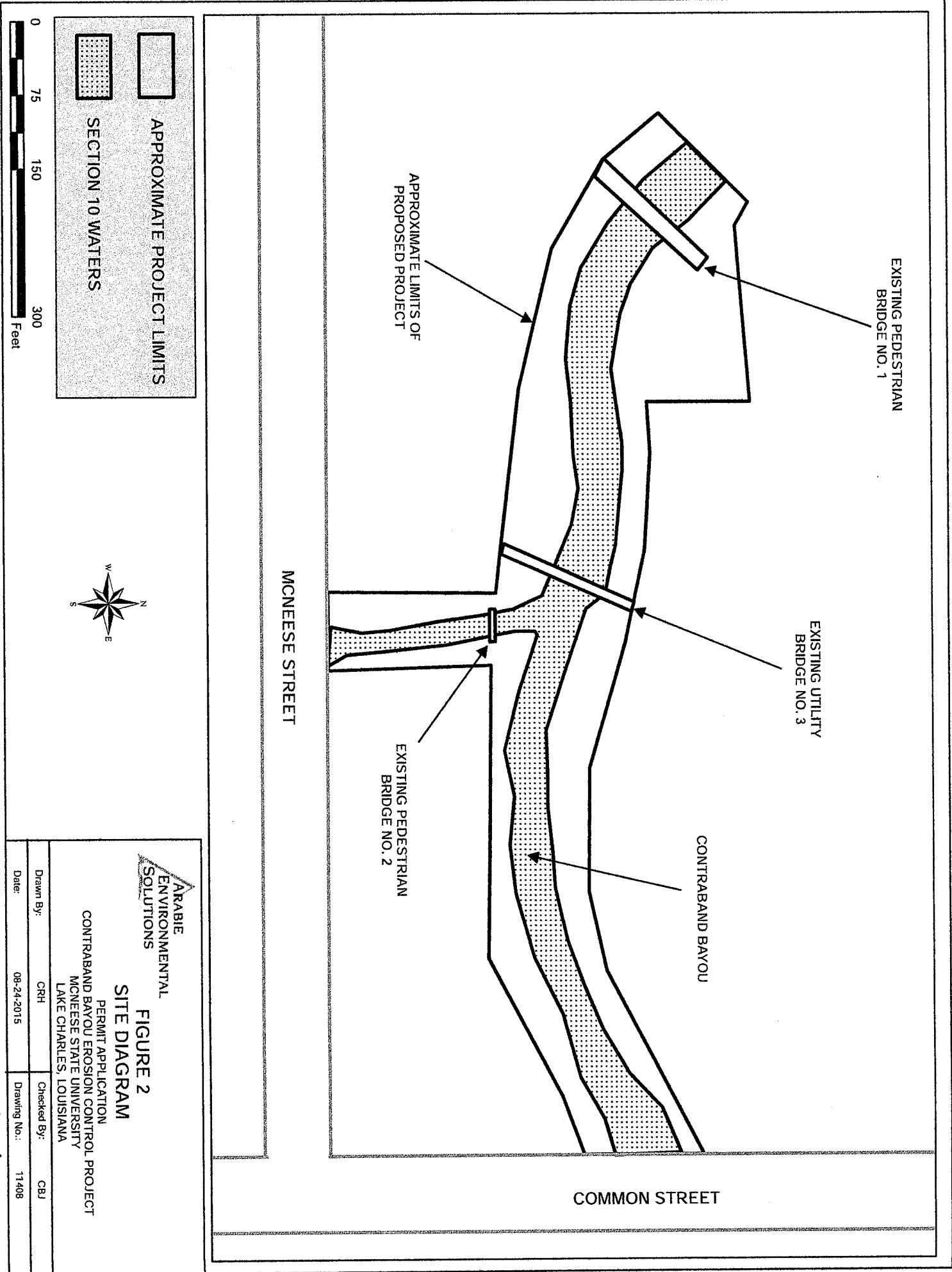

ARABIE  
ENVIRONMENTAL  
SOLUTIONS

**FIGURE 2  
SITE DIAGRAM**

PERMIT APPLICATION  
CONTRABAND BAYOU EROSION CONTROL PROJECT  
MCNEESE STATE UNIVERSITY  
LAKE CHARLES, LOUISIANA

Drawn By:	CRH	Checked By:	CBJ
Date:	08-24-2015	Drawing No.:	11-408

12/21/15



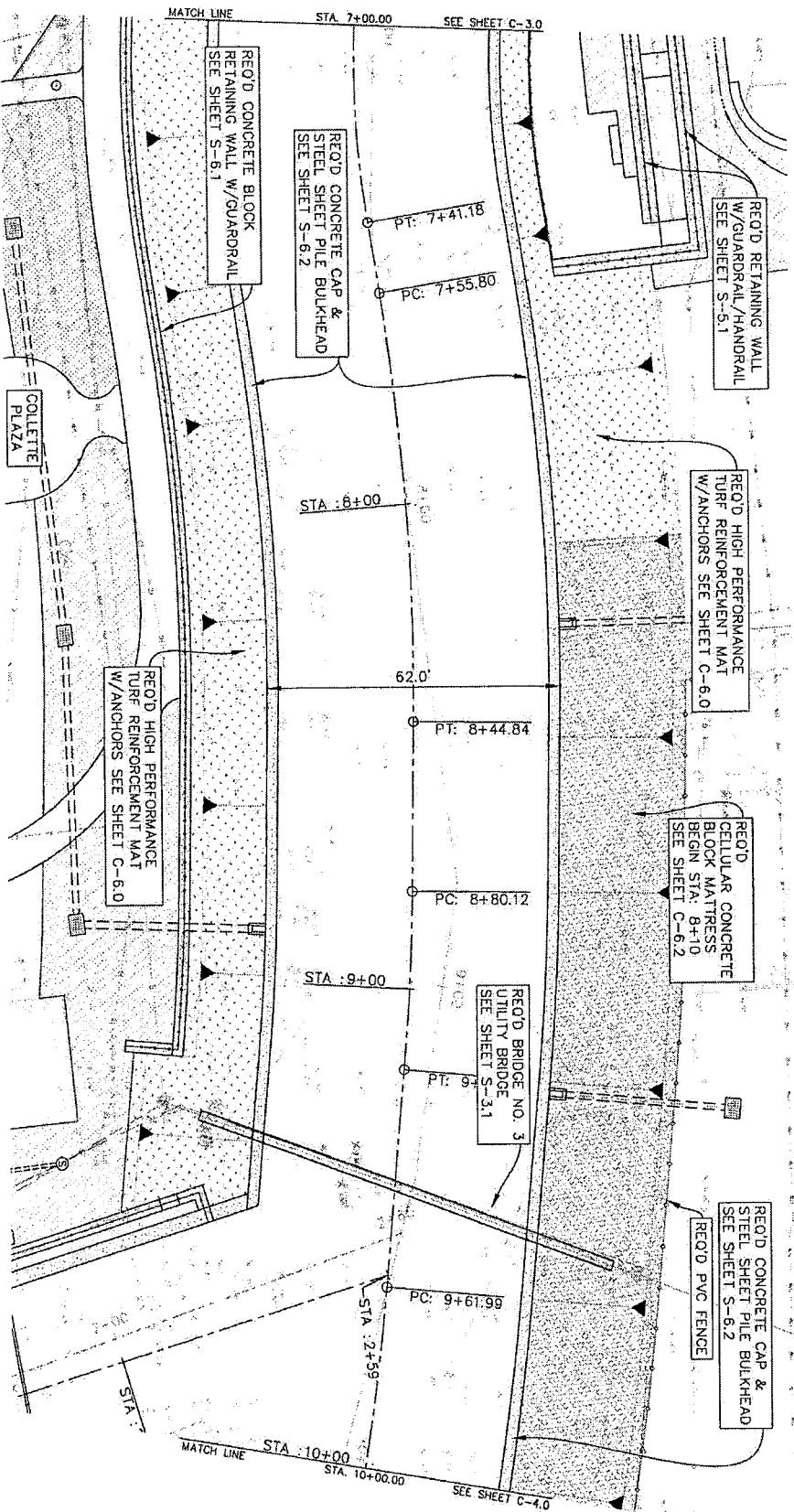

DRAWING PROVIDED BY MEYER & ASSOCIATES, INC

ARABIE  
ENVIRONMENTAL  
SOLUTIONS

FIGURE 4  
SITE PLAN

Rev 12-7-15

PERMIT APPLICATION  
CONTRABAND BAYOU EROSION CONTROL PROJECT  
MCNEESE STATE UNIVERSITY  
LAKE CHARLES, LOUISIANA

Drawn By:

Date: 08/24/2016

Checked By:

Drawing No: 11408

12/21/15

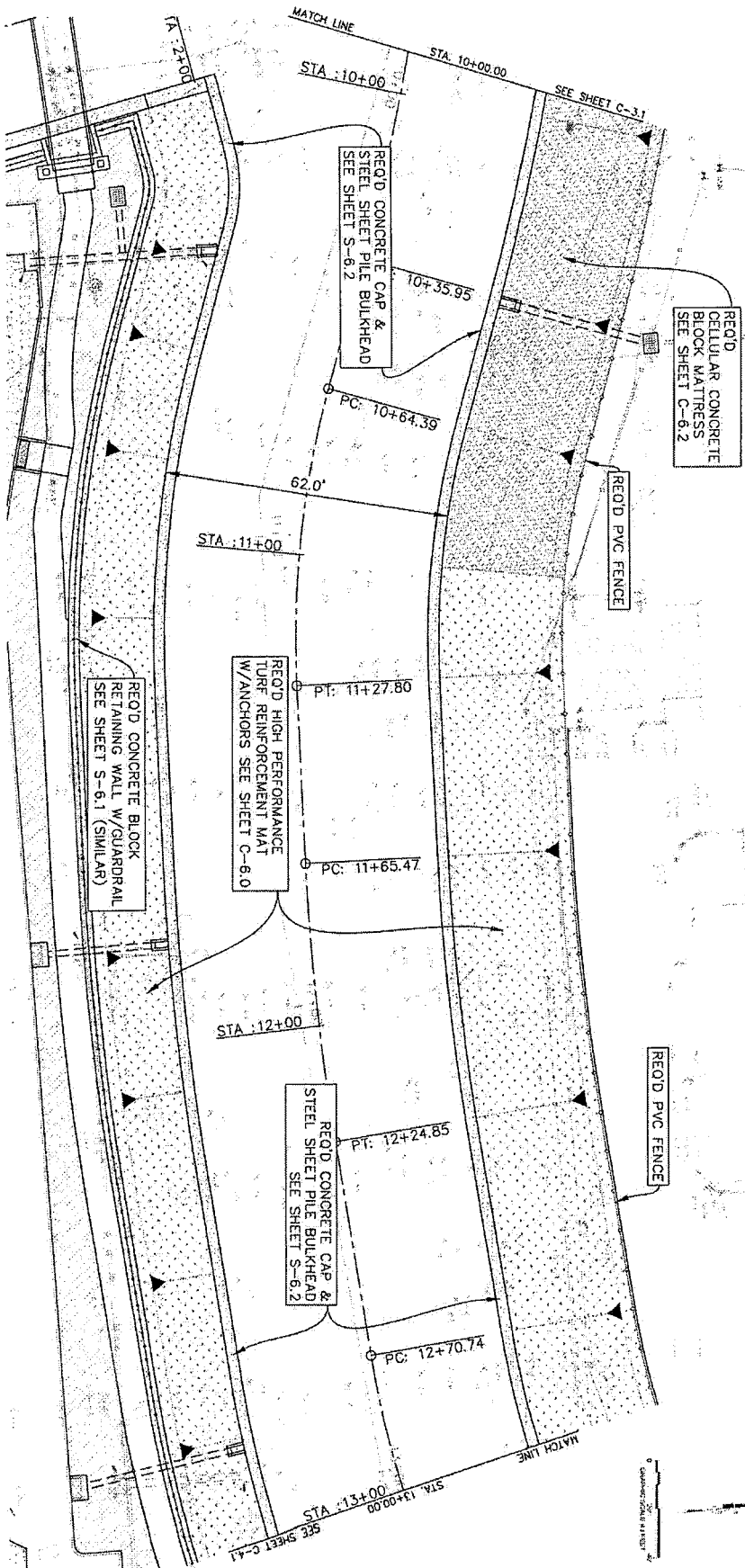

DRAWING PROVIDED BY MEYER & ASSOCIATES, INC

ARABIE  
ENVIRONMENTAL  
SOLUTIONS

FIGURE 5  
SITE PLAN

PERMIT APPLICATION  
CONTRABAND BAY/COASTAL EROSION CONTROL PROJECT  
MCNEESE STATE UNIVERSITY  
LAKE CHARLES, LOUISIANA

Rev 12-7-15

Drawn By: 08/24/2016  
Date: 11408  
Checked By: Drawing No:

12/21/15



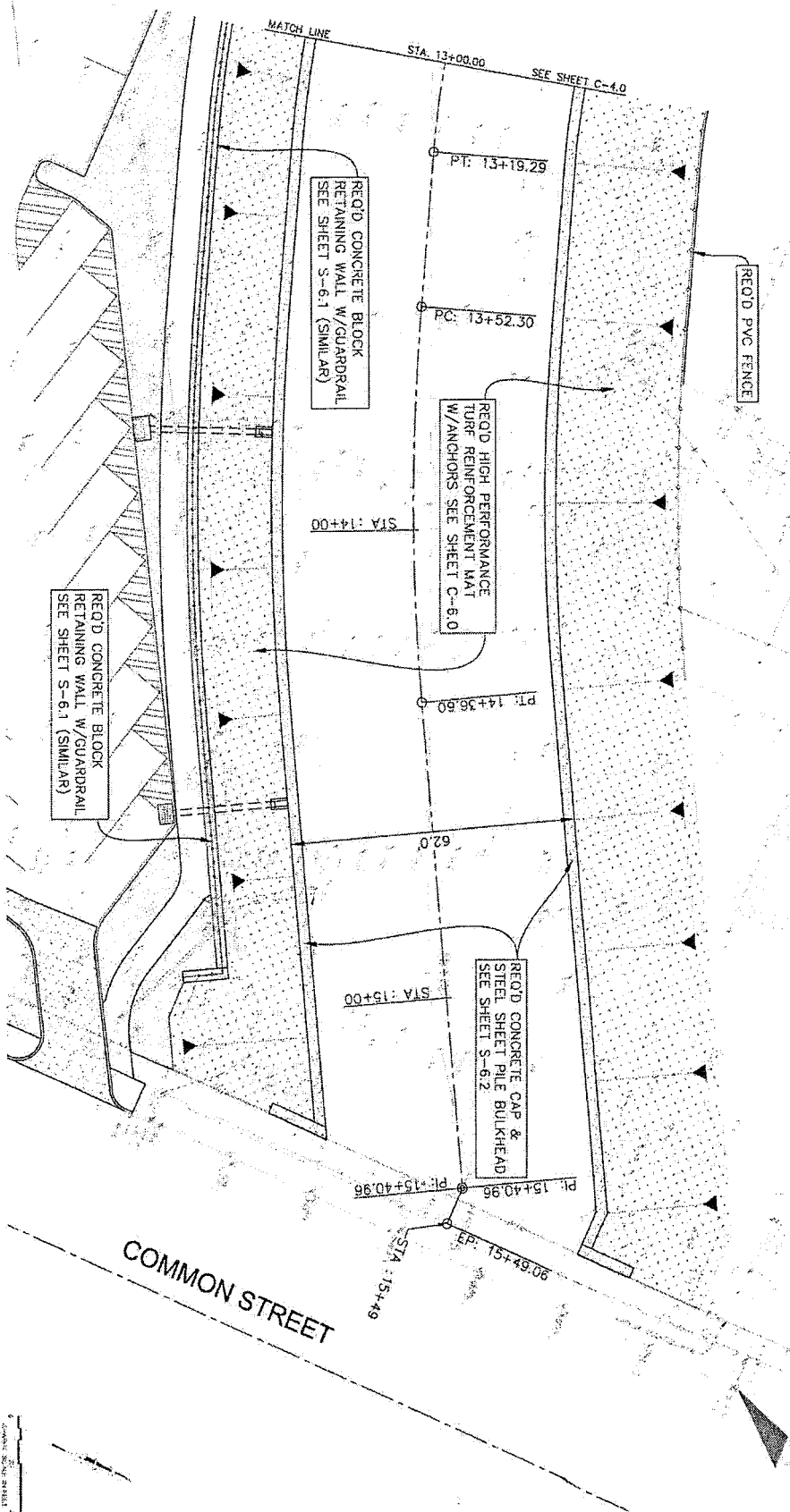

DRAWING PROVIDED BY MEYER & ASSOCIATES, INC

ARABIE ENVIRONMENTAL SOLUTIONS	
FIGURE 6 SITE PLAN	
PERMIT APPLICATION	
CONTRABAND BAYOU EROSION CONTROL PROJECT	
LAKE CHARLES, LOUISIANA	
Drawn By:	Checked By:
Date: 08/24/2016	Drawing No: 11408

Rev 12-7-15

12/21/15

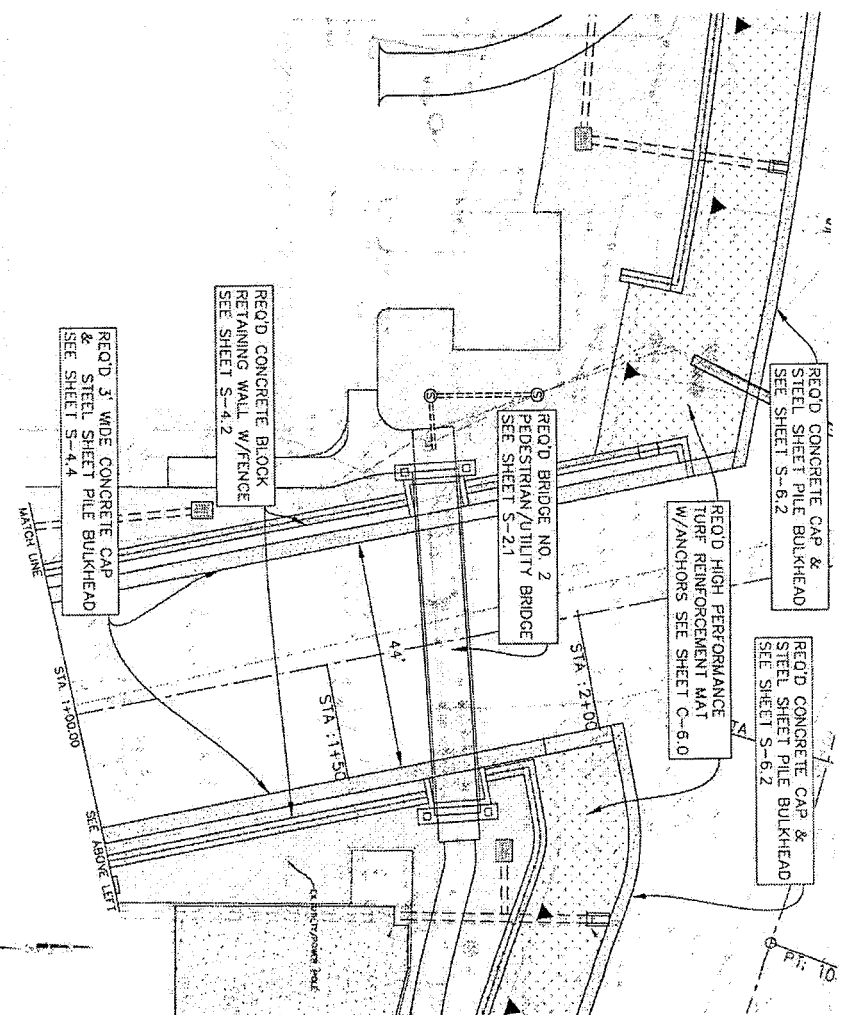
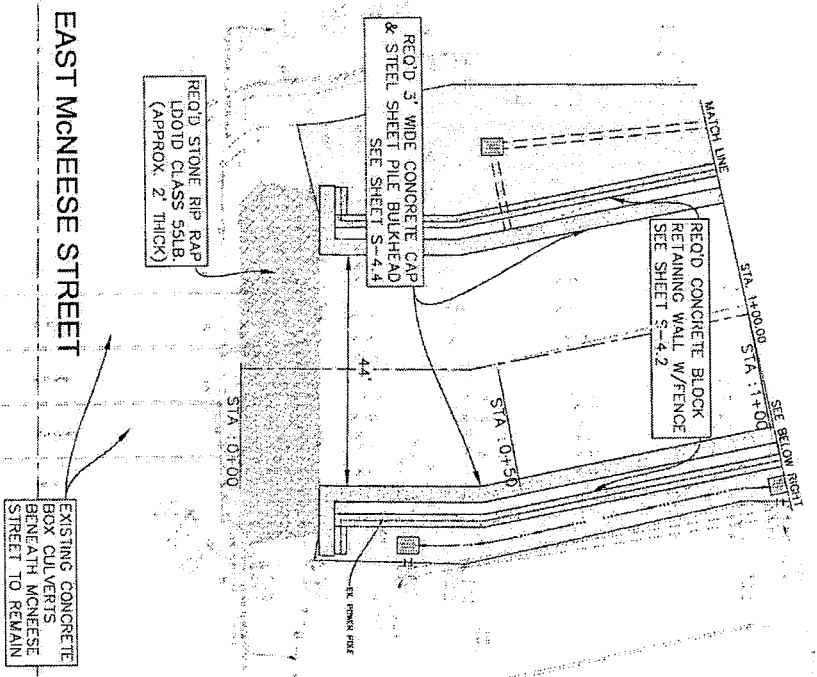

**EAST MCNEESE STREET**

DRAWING PROVIDED BY MEYER & ASSOCIATES, INC

ARABIE ENVIRONMENTAL SOLUTIONS  
FIGURE 7  
SITE PLAN  
Rev 12-7-15

PERMIT APPLICATION  
CONTRABAND BAYOU EROSION CONTROL PROJECT  
MCNEESE STATE UNIVERSITY  
LAKE CHARLES, LOUISIANA  
Drawn By: 08/24/2016  
Checked By: 11/08

12/21/15

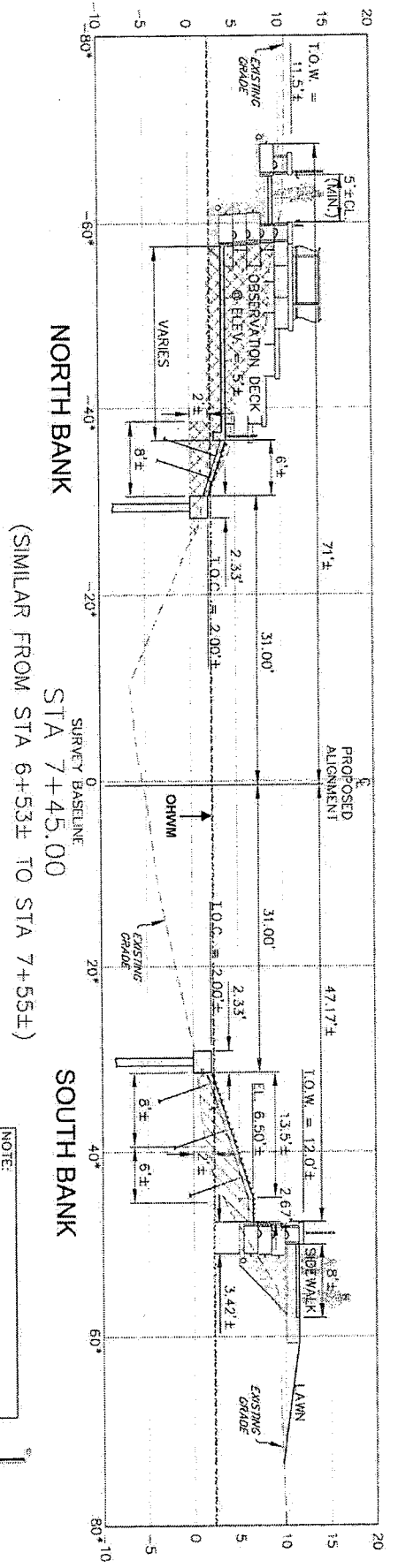

(SIMILAR FROM STA 6+53± TO STA 7+55±)

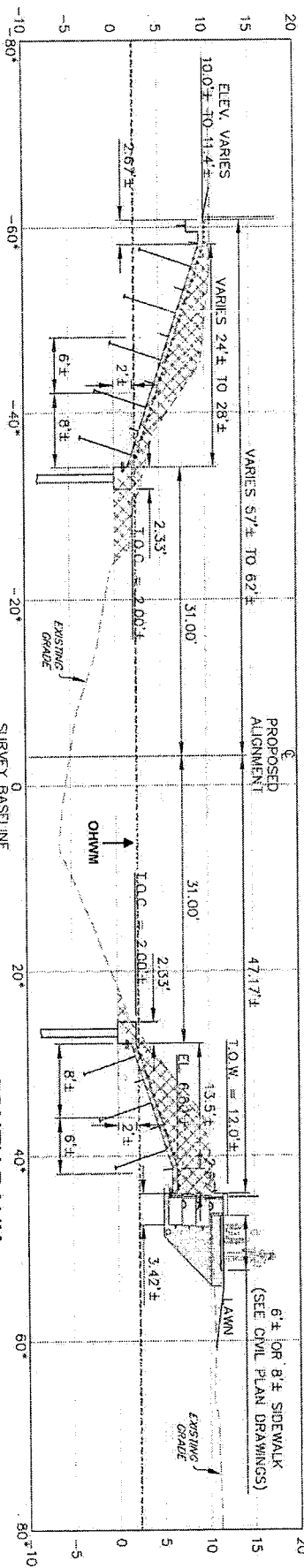

(TYPICAL ALONG SOUTH BANK OF BAYOU STA 5+83± TO STA 14+98± AND NORTH BANK OF BAYOU STA 5+00 TO STA 15+43±, LESS OBSERVATION DECK)

**FILL**  
**CUT**

DRAWING PROVIDED BY MEYER & ASSOCIATES, INC  
NOT TO SCALE DIMENSIONS AS NOTED.

ARABIE  
ENVIRONMENTAL  
SOLUTIONS

FIGURE 8  
TYPICAL SECTIONS  
PERMIT APPLICATION  
CONTRABAND BAYOU EROSION CONTROL PROJECT  
MCNEESE STATE UNIVERSITY  
LAKE CHARLES, LOUISIANA

Rev 12-7-15

Drawn By: 08/24/2016

Checked By:

Date: 08/24/2016

Drawing No: 11408

12/21/15

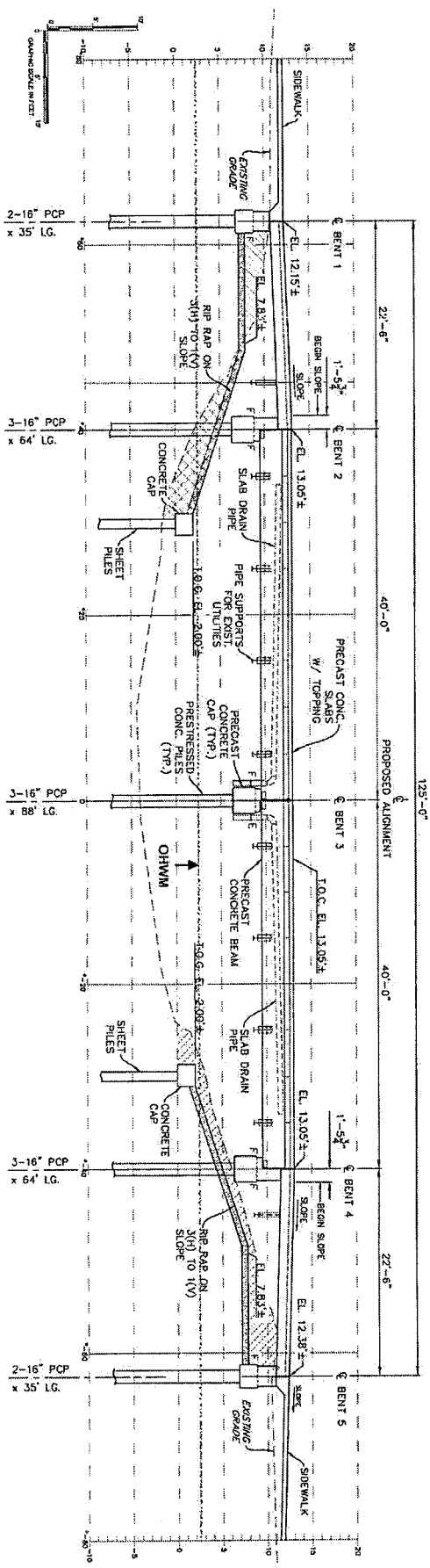
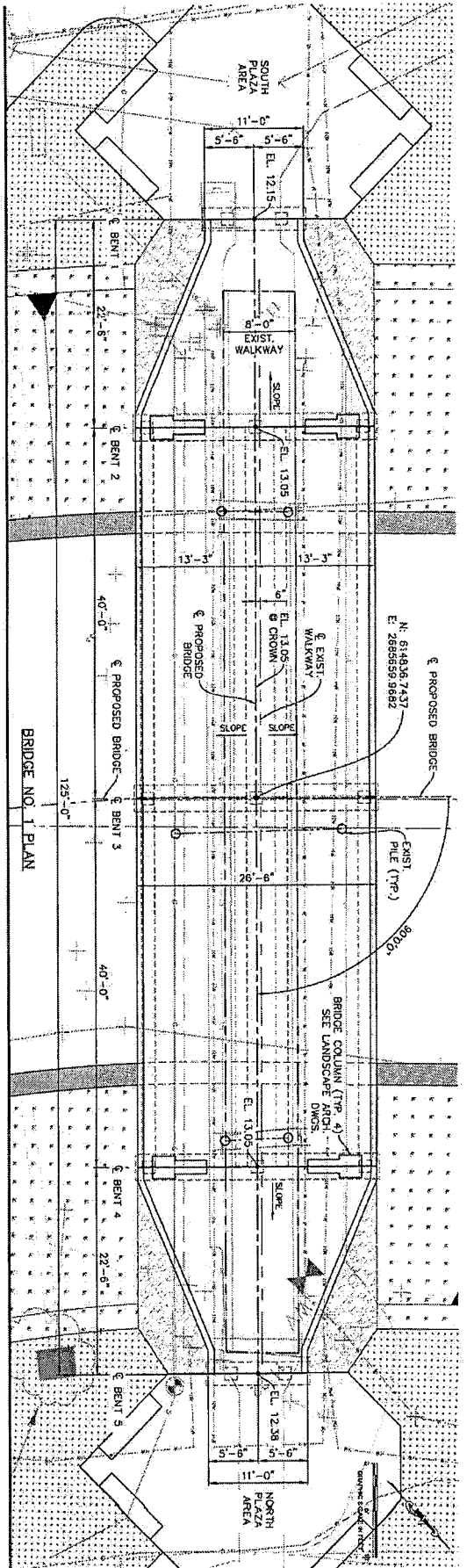

 FILL  
 CUT

DRAWING PROVIDED BY MEYER & ASSOCIATES, INC  
 NOT TO SCALE DIMENSIONS AS NOTED.

ARABIE ENVIRONMENTAL SOLUTIONS 1400 N. 10TH AVE. SUITE 100 CONRAD AND BAYOU EROSION CONTROL PROJECT LAKE CHARLES, LOUISIANA	FIGURE 9	REV 12-7-15
	BRIDGE 1 PLAN/PROFILE	12/21/15
Drawn By: 08/24/2016 Checked By: 11/08		

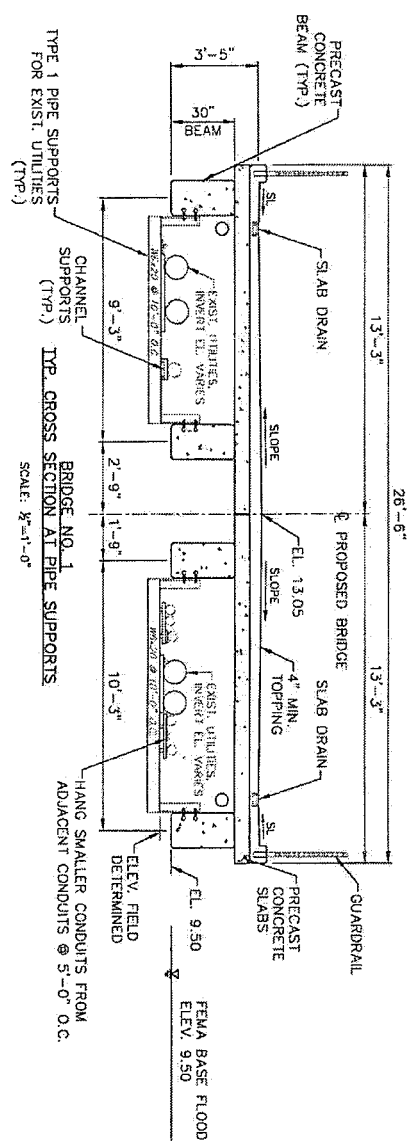
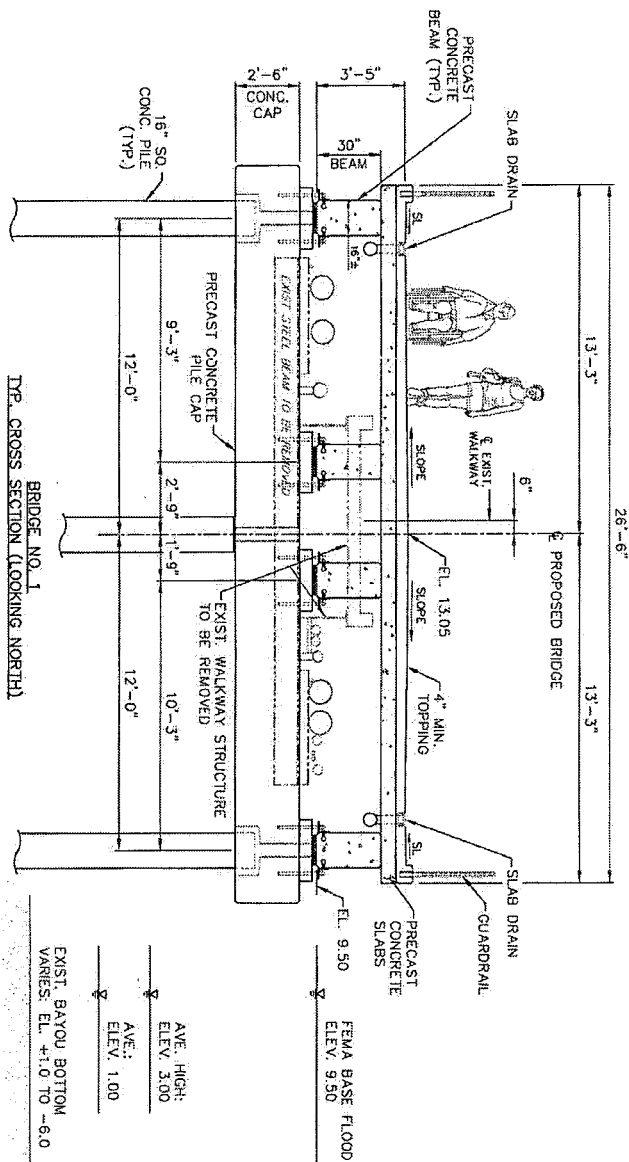

**STRUCTURAL DESIGN CRITERIA**

LIVE LOADS: 100 PSF

WIND LOADS: 132 MPH

SEISMIC: SOIL CLASSIFICATION D  
ACCELERATION PARAMETERS PER USGS  
IMPORTANCE FACTOR = 1.0  
RISK CATEGORY B

- NOTE:**
1. PIPE AND CONDUIT LOCATIONS AND ELEVATIONS ARE APPROXIMATE. FIELD VERIFY.
  2. SUPPORT AND SECURE ALL UTILITY PIPING AND CONDUIT UTILIZING CHANNEL SUPPORT SYSTEMS SUCH AS UNISTRUT OR HAFFEN.
  3. SUPPORT UTILITIES AT THE CURRENT GENERAL POSITIONS AND ELEVATIONS.
  4. SUPPORTING MATERIALS SHALL BE HOT DIP GALVANIZED AFTER FABRICATION. NO FIELD WELDING.
  5. SMALL CONDUITS MAY BE SUPPORTED FROM LARGER PIPES AND CONDUIT.
  6. INSTALL PIPE CLAMP AT EACH SUPPORT POINT.

DRAWING PROVIDED BY MEYER & ASSOCIATES, INC  
NOT TO SCALE DIMENSIONS AS NOTED.

ARABIE

ENVIRONMENTAL

SOLUTIONS

FIGURE 10

BRIDGE 1 TYP. CROSS SECTION

CONTRABAND BAYOU EROSION CONTROL PROJECT

MCNEESE STATE UNIVERSITY

LAKE CHARLES, LOUISIANA

Drawn By:

08/24/2016

Checked By:

11408

REV 12-7-15

12/21/15

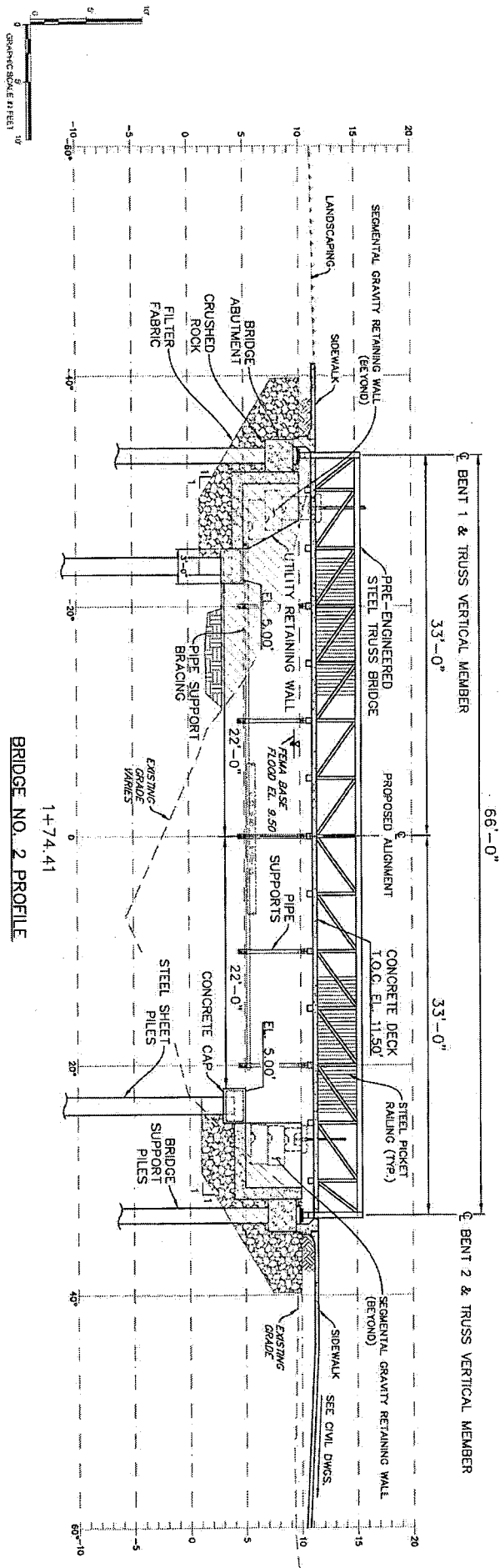

BRIDGE NO. 2 PROFILE

1+74.41

FILL  
CUT

DRAWING PROVIDED BY MEYER & ASSOCIATES, INC  
NOT TO SCALE DIMENSIONS AS NOTED.

ARABIE  
ENVIRONMENTAL  
SOLUTIONS

FIGURE 11  
BRIDGE 2 PROFILE

PERMIT APPLICATION  
CONTRABAND BAYOU EROSION CONTROL PROJECT  
LAKE CHARLES, LOUISIANA

REV 12-7-15

Drawn By: 08/24/2016  
Checked By: 11/4/08

12/21/15

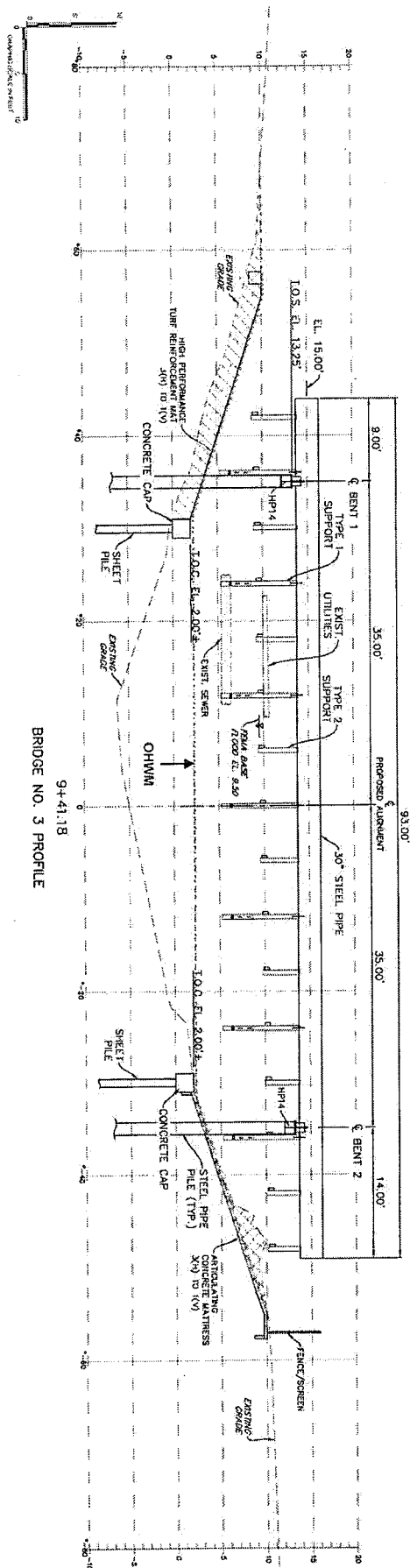
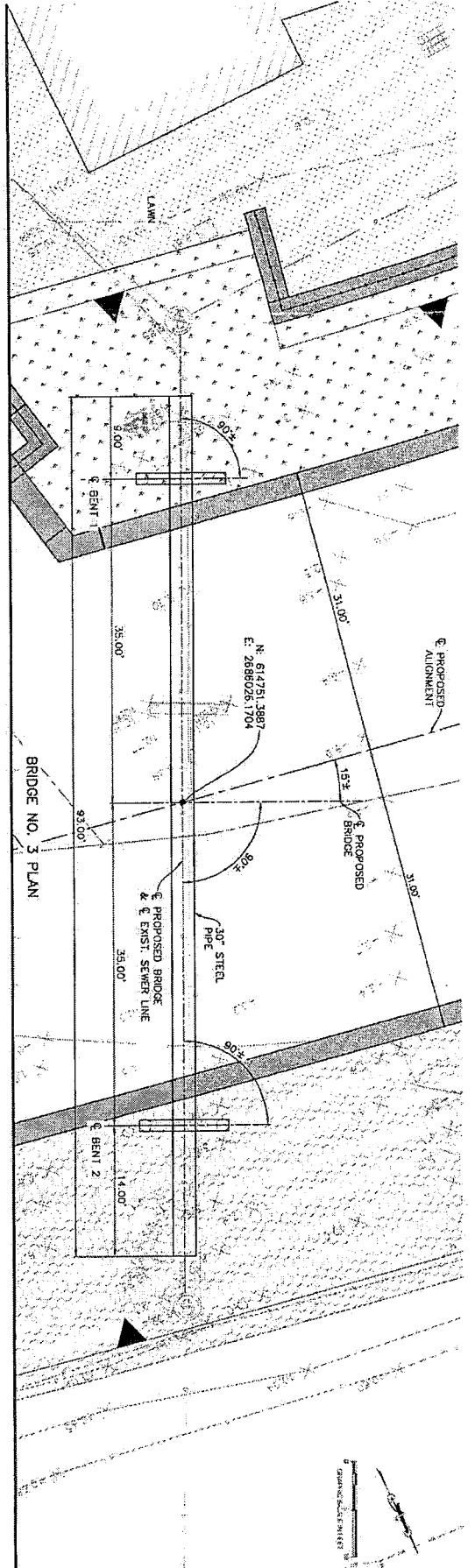

FILL  
 CUT

DRAWING PROVIDED BY MEYER & ASSOCIATES, INC.  
 NOT TO SCALE DIMENSIONS AS NOTED.  
 UTILITY BRIDGE NOT TO BE USED FOR PEDESTRIANS.

ARABIE ENVIRONMENTAL SOLUTIONS  
 FIGURE 12  
 BRIDGE 3 PLAN/PROFILE  
 PERMIT APPLICATION  
 CONTRABAND BAYOU EROSION CONTROL PROJECT  
 MONROE STATE UNIVERSITY  
 LAKE CHARLES, LOUISIANA

REV 12-7-15  
 Drawn By: 08/24/2015  
 Checked By: Drawing No: 11408

